

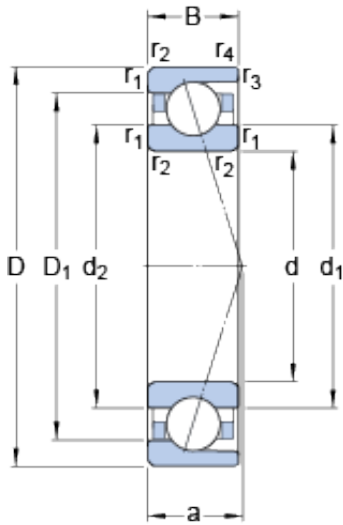

NTL BEARINGS LTD.

7215 CD/HCP4A SKF High Speed Angular Contact Ball Bearings

Bearing No. 7215 CD/HCP4A



7215 CD/HCP4A Bearing 2D drawings and 3D CAD models

Size	130x75x25 mm
Bore Diameter	130 mm
Outer Diameter	75 mm
Width	25 mm
d	75 mm
D	130 mm
B	25 mm
d ₁	92.9 mm
d ₂	92.9 mm
D ₁	112.1 mm
r _{1,2} - min.	1.5 mm
r _{3,4} - min.	0.6 mm
a	26.3 mm
d _a - min.	84 mm
d _b - min.	84 mm
D _a - max.	121 mm
D _b - max.	125.8 mm
r _a - max.	1.5 mm
r _b - max.	0.6 mm
d _n	96.6 mm
Basic dynamic load rating - C	71.5 kN
Basic static load rating - C ₀	62 kN
Fatigue load limit - P _u	2.6 kN
Limiting speed for grease	14000 r/min



NTL BEARINGS LTD.

Lubrication	
Limiting speed for oil lubrication	20000 mm/min
Ball - D_w	15.875 mm
Ball - z	17
G_{ref}	14.895 cm ³
Calculation factor - f_0	15
Preload class A - G_A	270 N
Preload class B - G_B	540 N
Preload class C - G_C	1080 N
Preload class D - G_D	2160 N
Calculation factor - f	1.08
Calculation factor - f	1
Calculation factor - f_{2A}	1
Calculation factor - f_{2B}	1.01
Calculation factor - f_{2C}	1.03
Calculation factor - f_{2D}	1.06
Calculation factor - f_{HC}	1.01
Preload class A	97 N/micron
Preload class B	131 N/micron
Preload class C	183 N/micron
Preload class D	263 N/micron
d_1	92.9 mm
d_2	92.9 mm
D_1	112.1 mm
$r_{1,2}$ min.	1.5 mm
$r_{3,4}$ min.	0.6 mm
d_a min.	84 mm
d_b min.	84 mm
D_a max.	121 mm



NTL BEARINGS LTD.

D_b max.	125.8 mm
r_a max.	1.5 mm
r_b max.	0.6 mm
d_n	96.6 mm
Basic dynamic load rating C	71.5 kN
Basic static load rating C_0	62 kN
Fatigue load limit P_u	2.65 kN
Attainable speed for grease lubrication	14000 r/min
Attainable speed for oil-air lubrication	20000 r/min
Ball diameter D_w	15.875 mm
Number of balls z	17
Reference grease quantity G_{ref}	14.895 cm ³
Preload class A G_A	270 N
Static axial stiffness, preload class A	97 N/ μ m
Preload class B G_B	540 N
Static axial stiffness, preload class B	131 N/ μ m
Preload class C G_C	1080 N
Static axial stiffness, preload class C	183 N/ μ m
Preload class D G_D	2160 N
Static axial stiffness, preload class D	263 N/ μ m
Calculation factor f	1.08
Calculation factor f_1	1
Calculation factor f_{2A}	1
Calculation factor f_{2B}	1.01
Calculation factor f_{2C}	1.03
Calculation factor f_{2D}	1.06
Calculation factor f_{HC}	1.01



NTL BEARINGS LTD.

Calculation factor f_0	15
Mass bearing	1.04 kg