

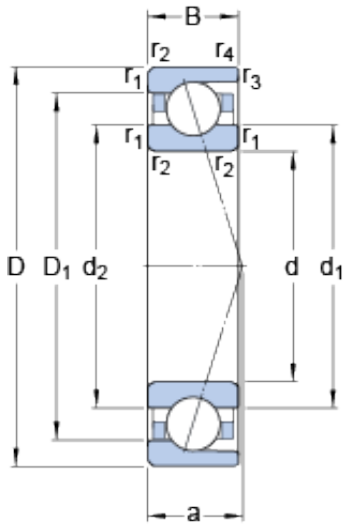

NTL BEARINGS LTD.

71813 ACD/P4 SKF High Speed Angular Contact Ball Bearings

Bearing No. 71813 ACD/P4



71813 ACD/P4 Bearing 2D drawings and 3D CAD models

Size	85x65x10 mm
Bore Diameter	85 mm
Outer Diameter	65 mm
Width	10 mm
d	65 mm
D	85 mm
B	10 mm
d ₁	71.7 mm
d ₂	71.7 mm
D ₁	78.5 mm
r _{1,2} - min.	0.6 mm
r _{3,4} - min.	0.3 mm
a	22.5 mm
d _a - min.	68.2 mm
d _b - min.	68.2 mm
D _a - max.	81.8 mm
D _b - max.	83 mm
r _a - max.	0.6 mm
r _b - max.	0.3 mm
d _n	72.4 mm
Basic dynamic load rating - C	12.7 kN
Basic static load rating - C ₀	14 kN
Fatigue load limit - P _u	0.585 kN
Limiting speed for grease	13000 r/min



NTL BEARINGS LTD.

Lubrication	
Limiting speed for oil lubrication	20000 mm/min
Ball - D_w	5.556 mm
Ball - z	29
G_{ref}	1.3 cm ³
Calculation factor - e	0.68
Calculation factor - Y_2	0.87
Calculation factor - Y_0	0.38
Calculation factor - X_2	0.41
Calculation factor - Y_1	0.92
Calculation factor - Y_2	1.41
Calculation factor - Y_0	0.76
Calculation factor - X_2	0.67
Preload class A - G_A	115 N
Preload class B - G_B	345 N
Preload class C - G_C	690 N
Calculation factor - f	1.28
Calculation factor - f_1	0.97
Calculation factor - f_{2A}	1
Calculation factor - f_{2B}	1.08
Calculation factor - f_{2C}	1.15
Calculation factor - f_{HC}	1
Preload class A	144 N/micron
Preload class B	227 N/micron
Preload class C	312 N/micron
d_1	71.7 mm
d_2	71.7 mm
D_1	78.5 mm
$r_{1,2}$ min.	0.6 mm



NTL BEARINGS LTD.

$r_{3,4}$ min.	0.3 mm
d_a min.	68.2 mm
d_b min.	68.2 mm
D_a max.	81.8 mm
D_b max.	83 mm
r_a max.	0.6 mm
r_b max.	0.3 mm
d_n	72.4 mm
Basic dynamic load rating C	12.7 kN
Basic static load rating C_0	14 kN
Fatigue load limit P_u	0.585 kN
Attainable speed for grease lubrication	13000 r/min
Attainable speed for oil-air lubrication	20000 r/min
Ball diameter D_w	5.556 mm
Number of balls z	29
Reference grease quantity G_{ref}	1.3 cm ³
Preload class A G_A	115 N
Static axial stiffness, preload class A	144 N/ μ m
Preload class B G_B	345 N
Static axial stiffness, preload class B	227 N/ μ m
Preload class C G_C	690 N
Static axial stiffness, preload class C	312 N/ μ m
Calculation factor f	1.28
Calculation factor f_1	0.97
Calculation factor f_{2A}	1
Calculation factor f_{2B}	1.08
Calculation factor f_{2C}	1.15
Calculation factor f_{HC}	1



NTL BEARINGS LTD.

Calculation factor e	0.68
Calculation factor (single, tandem) Y_2	0.87
Calculation factor (single, tandem) Y_0	0.38
Calculation factor (single, tandem) X_2	0.41
Calculation factor (back-to-back, face-to-face) Y_1	0.92
Calculation factor (back-to-back, face-to-face) Y_2	1.41
Calculation factor (back-to-back, face-to-face) Y_0	0.76
Calculation factor (back-to-back, face-to-face) X_2	0.67
Mass bearing	0.13 kg