

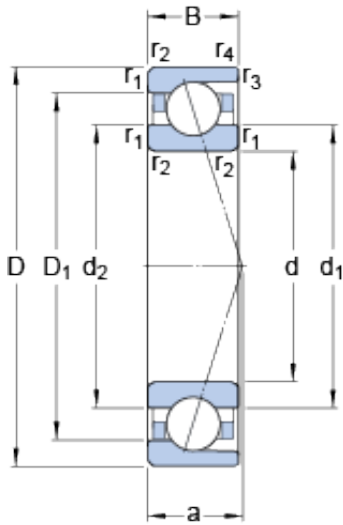

NTL BEARINGS LTD.

71913 ACD/HCP4A SKF High Speed Angular Contact Ball Bearings

Bearing No. 71913 ACD/HCP4A



71913 ACD/HCP4A Bearing 2D drawings and 3D CAD models

Size	90x65x13 mm
Bore Diameter	90 mm
Outer Diameter	65 mm
Width	13 mm
d	65 mm
D	90 mm
B	13 mm
d ₁	72.7 mm
d ₂	72.7 mm
D ₁	82.3 mm
r _{1,2} - min.	1 mm
r _{3,4} - min.	0.3 mm
a	24.7 mm
d _a - min.	69.6 mm
d _b - min.	69.6 mm
D _a - max.	85.4 mm
D _b - max.	88 mm
r _a - max.	1 mm
r _b - max.	0.3 mm
d _n	74.7 mm
Basic dynamic load rating - C	19.5 kN
Basic static load rating - C ₀	16 kN
Fatigue load limit - P _u	0.68 kN
Limiting speed for grease	15000 r/min



NTL BEARINGS LTD.

Lubrication	
Limiting speed for oil lubrication	24000 mm/min
Ball - D_w	7.938 mm
Ball - z	26
G_{ref}	2.85 cm ³
Calculation factor - e	0.68
Calculation factor - Y_2	0.87
Calculation factor - Y_0	0.38
Calculation factor - X_2	0.41
Calculation factor - Y_1	0.92
Calculation factor - Y_2	1.41
Calculation factor - Y_0	0.76
Calculation factor - X_2	0.67
Preload class A - G_A	120 N
Preload class B - G_B	240 N
Preload class C - G_C	480 N
Preload class D - G_D	960 N
Calculation factor - f	1.2
Calculation factor - f_1	0.98
Calculation factor - f_{2A}	1
Calculation factor - f_{2B}	1.07
Calculation factor - f_{2C}	1.12
Calculation factor - f_{2D}	1.17
Calculation factor - f_{HC}	1.04
Preload class A	151 N/micron
Preload class B	196 N/micron
Preload class C	257 N/micron
Preload class D	345 N/micron



NTL BEARINGS LTD.

Category	Precision Ball Bearings
Inventory	0.0
Manufacturer Name	SKF
Minimum Buy Quantity	N/A
Weight / Kilogram	0
Product Group	B04270
Enclosure	Open
Precision Class	ABEC 7 ISO P4
Material - Ball	Ceramic
Number of Bearings	1 (Single)
Contact Angle	25 Degree
Preload	None
Raceway Style	1 Rib Outer Ring
Cage Material	Phenolic
Rolling Element	Ball Bearing
Flush Ground	No
Inch - Metric	Metric
Other Features	Single Row Angular Contact High Capacity Basic Design
Long Description	65MM Bore; 90MM Outside Diameter; 13MM Width; Open Enclosure; ABEC 7 ISO P4 Precision; Ceramic Ball Material; 1 (Single) Bearing; 25 Degree Contact Angle; Phenolic Cage Material; 1 Rib Outer Ring Ra
Category	Precision Ball Bearings
UNSPSC	31171531
Harmonized Tariff Code	8482.10.50.28
Noun	Bearing
Keyword String	Ball Angular Contact
Manufacturer URL	http://www.skf.com



NTL BEARINGS LTD.

Width	0.512 Inch 13 Millimeter
Bore	2.559 Inch 65 Millimeter
Outside Diameter	3.543 Inch 90 Millimeter
d_1	72.7 mm
d_2	72.7 mm
D_1	82.3 mm
$r_{1,2}$ min.	1 mm
$r_{3,4}$ min.	0.3 mm
d_a min.	69.6 mm
d_b min.	69.6 mm
D_a max.	85.4 mm
D_b max.	88 mm
r_a max.	1 mm
r_b max.	0.3 mm
d_n	74.7 mm
Basic dynamic load rating C	19.5 kN
Basic static load rating C_0	16 kN
Fatigue load limit P_u	0.68 kN
Attainable speed for grease lubrication	15000 r/min
Attainable speed for oil-air lubrication	24000 r/min
Ball diameter D_w	7.938 mm
Number of balls z	26
Reference grease quantity G_{ref}	2.85 cm ³
Preload class A G_A	120 N
Static axial stiffness, preload class A	151 N/ μ m
Preload class B G_B	240 N
Static axial stiffness, preload class B	196 N/ μ m
Preload class C G_C	480 N
Static axial stiffness, preload	257 N/ μ m



NTL BEARINGS LTD.

class C	
Preload class D G_D	960 N
Static axial stiffness, preload class D	345 N/ μ m
Calculation factor f	1.2
Calculation factor f_1	0.98
Calculation factor f_{2A}	1
Calculation factor f_{2B}	1.07
Calculation factor f_{2C}	1.12
Calculation factor f_{2D}	1.17
Calculation factor f_{HC}	1.04
Calculation factor e	0.68
Calculation factor (single, tandem) Y_2	0.87
Calculation factor (single, tandem) Y_0	0.38
Calculation factor (single, tandem) X_2	0.41
Calculation factor (back-to-back, face-to-face) Y_1	0.92
Calculation factor (back-to-back, face-to-face) Y_2	1.41
Calculation factor (back-to-back, face-to-face) Y_0	0.76
Calculation factor (back-to-back, face-to-face) X_2	0.67
Mass bearing	0.17 kg